

## Instructions for Use- Low Torque Indicating Ratchet Wrench

**Intended use:** A dental torque wrench used for the adjustment of abutments, abutment screws and prosthetic screws during oral surgery and prosthetic procedures.

**Scale Unit:** Ncm

**Attention:**

- **Device must be autoclaved prior to use.**
- **This device must not be cleaned using hydrogen peroxide.**

**Step 1:** Cleaning. Remove the adapter from the head. To remove the head of the wrench from the body, press the recessed area and gently pull the head (Fig. 1). The three parts (adapter, head and body) are now ready for cleaning using water, a brush and an autoclave. Autoclave/steam gravity sterilize for 40 minutes at 270-275°F (132-135°C).

**Step 2:** After cleaning, attach the head of the wrench to the body by pushing the components together and turning in opposite directions until there is an audible click. Insert the adapter into the head of the wrench until there is an audible click (Fig.2).

The arrow on the head of the wrench shows the direction in which the wrench is functioning. In addition, the head is labeled “IN” and “OUT”. “IN” denotes clockwise; “OUT” denotes counterclockwise. To change direction, flip the wrench to the opposite side and modify the adapter positioning accordingly (Fig. 3).

**Step 3:** To use as a conventional wrench, hold the main body and torque arm together with thumb and index finger. Turn the wrench in the direction of the arrow (Fig.4).

**Attention: The conventional wrench function may not be subjected to a load of more than 80 Ncm.**

**Step 4:** To use as a torque indicator, push the torque arm to turn the wrench in the desired direction. Prior to using as a torque indicator, verify the arrow is positioned at the first scale mark (0 Ncm) (Fig. 5).

**Attention: The indicator arm of the wrench must not go beyond the end of the scale, as this could result in inaccurate torque readings and/or damage to the device.**

**WARNING:** In the event that the wrench is overloaded, it must no longer be used. Correct function can no longer be guaranteed.

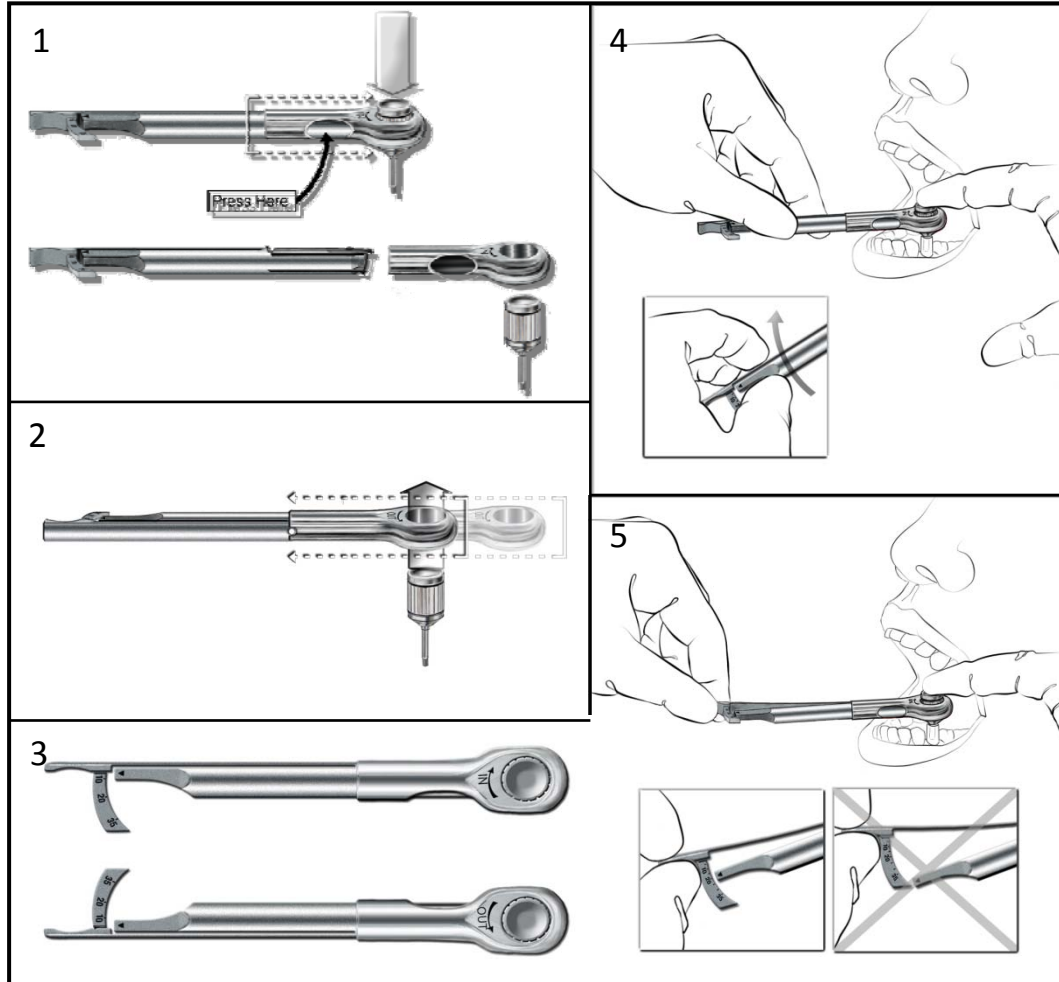

---

Caution: U.S. Federal Law restricts this device to sale by or on the order of a licensed dentist or physician.

---

**MANUFACTURER:**

Elos Pinol A/S  
Engvej 33  
DK – 3330 Gørløse

E

**DISTRIBUTED BY:**

BIOMET 3i  
4555 Riverside Drive  
Palm Beach Gardens, FL 33410  
1-800-342-5454  
Outside The U.S.: +1-561-776-6700  
Fax: +1-561-776-1272  
[www.biomet3i.com](http://www.biomet3i.com)

C9828 rev. 0

6 : Date of Manufacture



: Manufacturer

5 : Catalogue number

4 Lot Number



: Consult IFU

X : By prescription only



: Non Sterile